



SUN CITY CENTER

02.28.23 February Focus
Group – “WHAT”

Schedule

[illegible]

-
- The site plan illustrates a proposed development at the intersection of Highway 101 and Highway 102. The central area features a large blue pond, surrounded by various buildings and green spaces. Key features include a relocated club, a new outdoor theater, a bar, a cafe/patio, a kitchen, a billiards area, an event pavilion, a drive-in car wash, a playground, a pottery studio, a ceramics studio, a weavers studio, a stained glass studio, a music studio, a boardwalk, a pathway park, a memorial, and a boardwalk. The plan also shows existing buildings, parking lots, and a road network.

- Design Vignettes
- Discuss the aspects
- Feedback opportunities

- Phasing
- Budget

Survey Results:

- 183 sheets processed; 60 responses
- Majority chose framework C

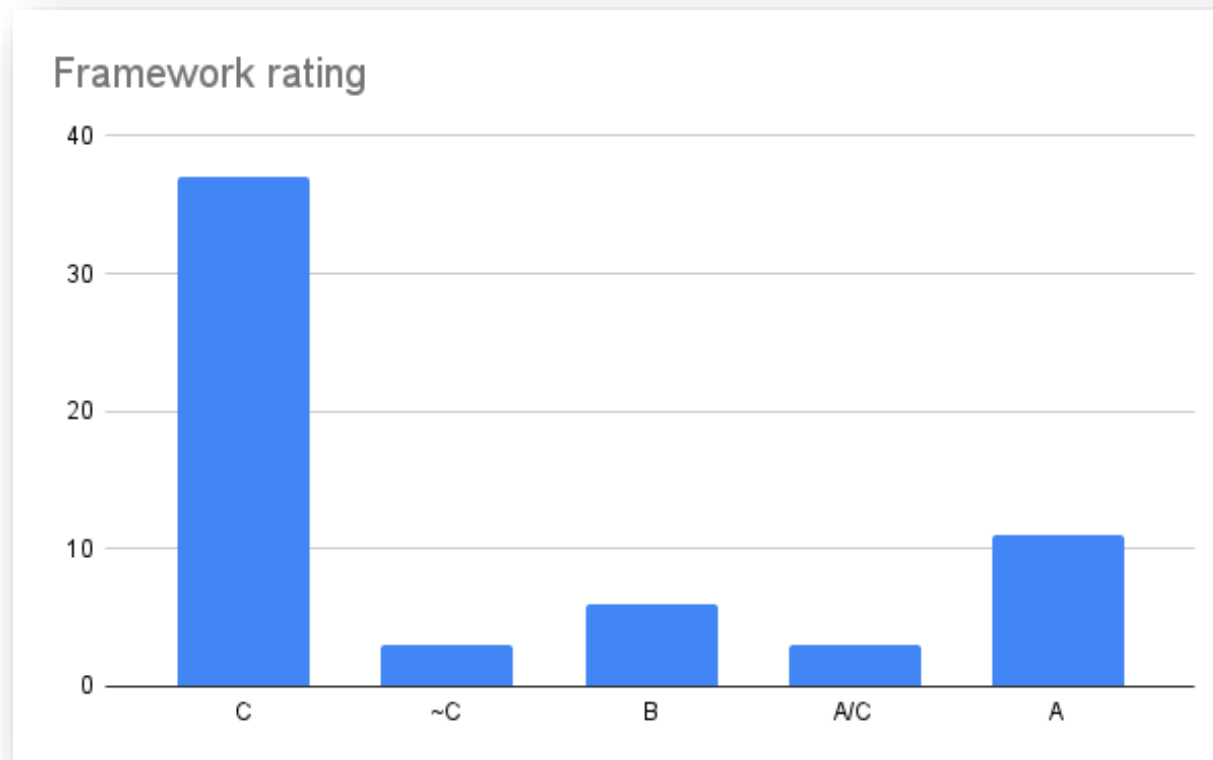



Summary:

- Open space: leave for future development
- Design: connectivity of uses
- Activity center: promote gathering
- Cherry Hills Drive: connect Artesian Plaza to lake side
- Increase parking options
- Incorporate all ideas as supporting elements for long term plans

Connectivity

- Artesian Plaza
- Radial Park and Trail / Boardwalk
- Oasis Recreation and Entertainment Plaza



Design Option A

- ✓ Visually expand interior campus
- ✓ Connect to lake
- ✓ Expand parking options
- ✓ Seating / Gathering options
- ✓ Group like uses and resources
- ✓ Shade and ventilation
- ✓ Low maintenance landscaping / hardscaping



Design Option A



Design Option B



Relocated
Clubs

Design Option C

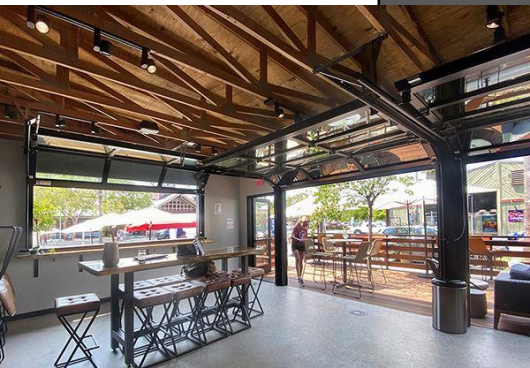
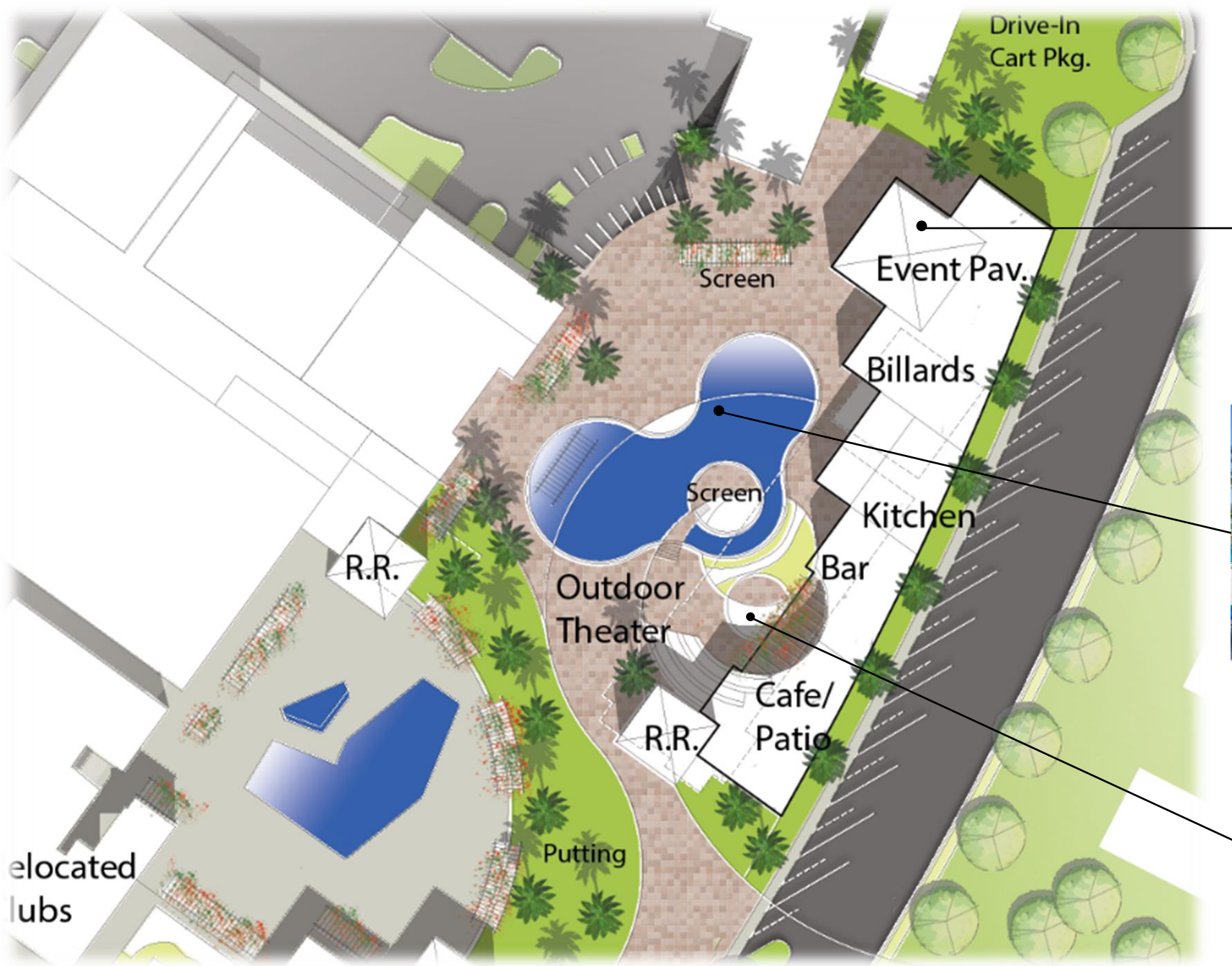

Design Option A



Design Option A



Design Option A

- ✓ Visually expand interior campus
- ✓ Connect to lake
- ✓ Expand parking options
- ✓ Seating / Gathering options
- ✓ Group like uses and resources
- ✓ Shade and ventilation
- ✓ Low maintenance landscaping / hardscaping



Differences:

- Keeps Maintenance Building
- Maximizes Open Space
- Uses Part of Rollins
- Compact Design

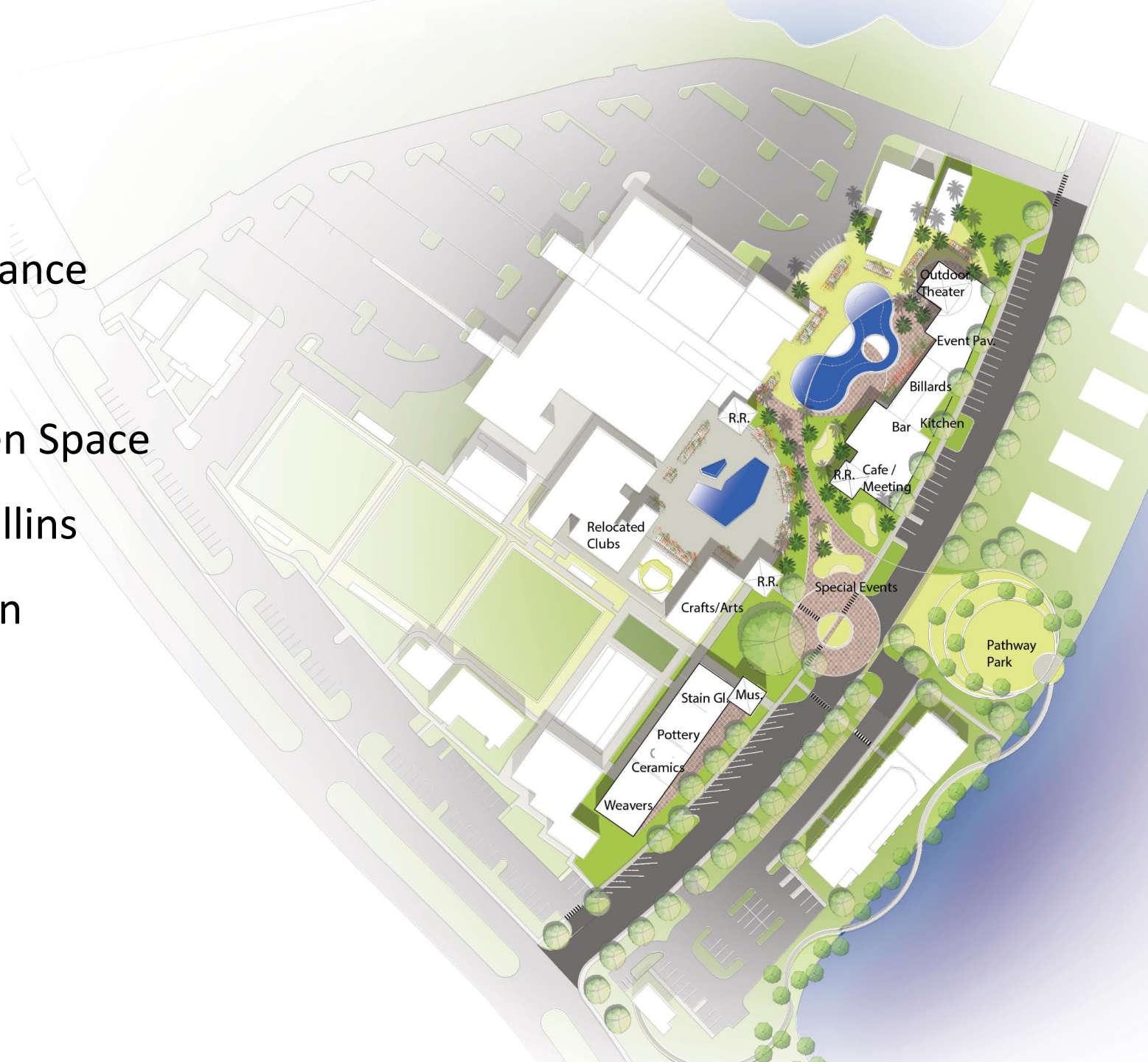

Design Option B

Differences:

- Keeps Maintenance Building
- Maximizes Open Space
- Least Amount of Rollins
- Provides More Interior Space



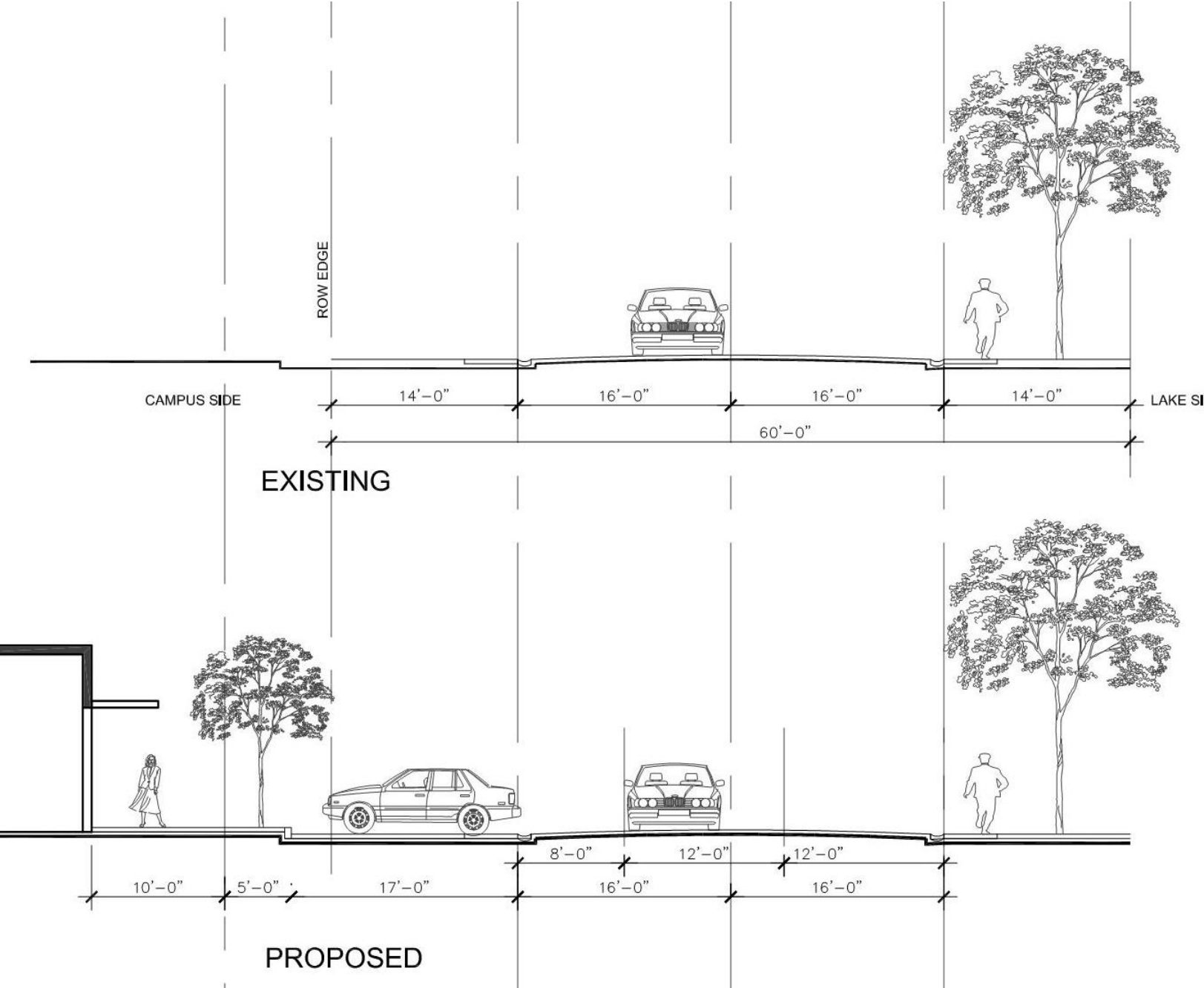

Schedule:

- Community Focus Group,
- February 28th community charrette - present options
- Solidify designs
- March 21st, final community focus group
- How (phasing plan) + how much